

Parts

CPLPBS36JD - 3.5 CU FT Broadcast Spreader

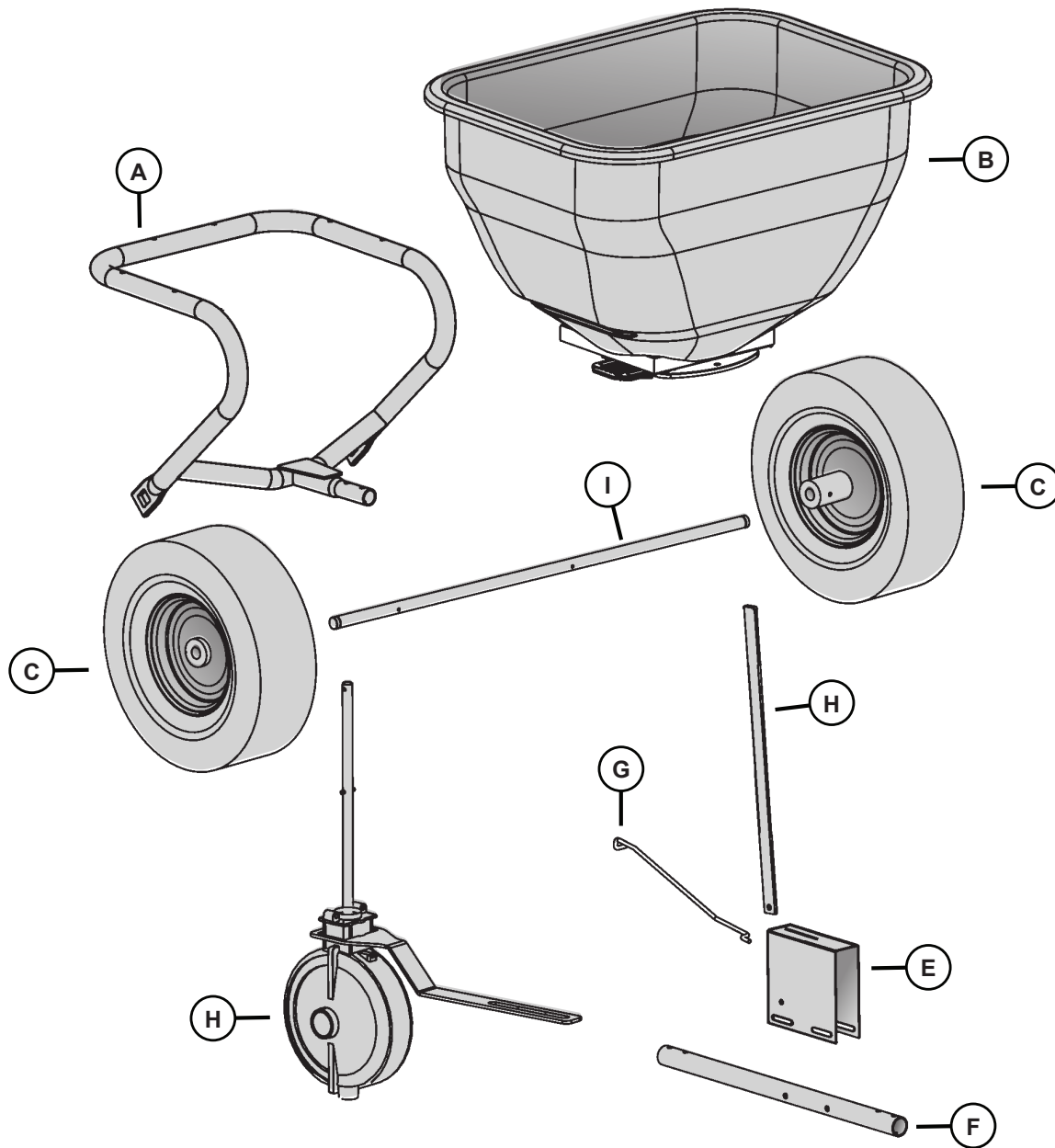

Ref.	Description	Qty.	Ref.	Description	Qty.
(A)	Support Frame, Hopper	CPF102910 1	(F)	Tube, Tow	CPF102310 1
(B)	Hopper ASM	CPF1002 1	(G)	Link Rod	CPF1010 1
	Hopper <i>(hopper w/ decals only)</i>	CPF1005	(H)	Transmission & Bracket	CPF1015 1
(C)	Wheel	CP1001607 2	(I)	Axle	CP101301 1
(D)	Handle, Flow Control	CPF100810 1			
(E)	Gage Plate	CPF100910 1			

Parts

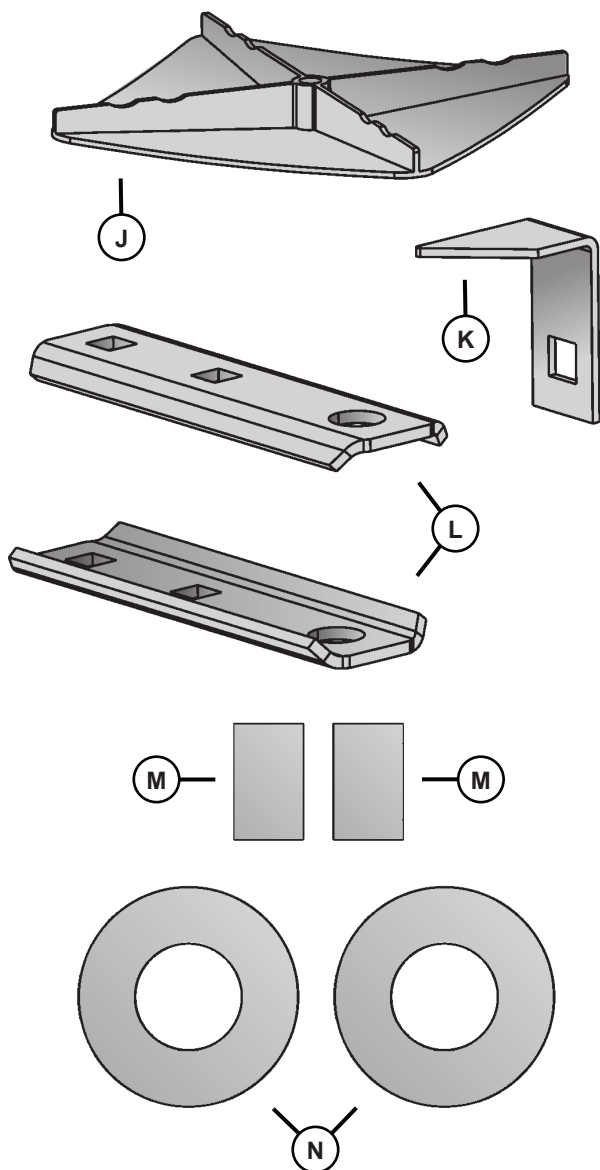

Hardware Bag (CP1019850)

Contents illustrated above

Ref.	Description	Qty.
(J)	Fan	CPF573 1
(K)	Handle Stop	CPF78101 1
(L)	Clevis, Hitch	CPR89210 2
(M)	Spacer, 3/8 in. wide for composite (plastic) rim wheels	CP100837801 2
(N)	Washer, 5/8 in. for composite (plastic) rim wheels	CP45M2121P 2

Hardware Skin Pack (CPZ1912)

Contents illustrated on page 7

Ref.	Description	Qty.
(O)	Washer, Flat, 5/8 in.	CP45M2121P 6
(P)	Nylon Locknut, 1/4 in.	CPB4785 6
(Q)	Nylon Washer, Flat, 1/4 in.	CPF575 6
(R)	Bolt, Hex, 1/4 x 1-3/4 in.	CP2M0828SS 6
(S)	Nylon Locknut, 5/16 in.	CPB4786 7
(T)	Bolt, Hex, 5/16 x 2-1/4 in.	CP2M1036PFT 2
(U)	Carriage Bolt, 5/16 x 2 in.	CP10M1032P 2
(V)	O-Ring, 3/8 in.	CPF365 1
(W)	Bolt, Hex, 5/16 x 2-3/4 in.	CP2M1044P 3
(X)	Washer, Curved Spring	CPF787 1
(Y)	Carriage Bolt, 5/16 x 3/4 in.	CP11M1012P 1
(Z)	Hitch Pin, 1/2 x 2-1/2 in.	CPB3861 1
(aa)	Fan Driver	CPF591 1
(bb)	Spacer, Latch	CPB3721 1
(cc)	Bushing, Pivot Plate	CPF104501 4
(dd)	Spring, Latch	CPB3805 1
(ee)	Cotter Pin, 1/8 x 1 in.	CP50M0416P 1
(ff)	Agitator Spring	CPF436 1
(gg)	Spring Locking Pin Open-Style	CPF620 1
(hh)	Spring Locking Pin Large Closed Style	CPB1002P 1
(ii)	Spring Locking Pin Small Closed-Style	CPD146P 1
(jj)	Grip, Flat	CPR1882 1
(kk)	Knob, 4-Prong	CPF782 1
(ll)	Bearing, Axle	CPF283 2
(mm)	Snap Ring, E-Type	CPF577 2
(nn)	Washer, Flat, 5/16 in.	CP45M1111P 8
(oo)	Washer, Special	CPR618 2
(pp)	Nut, Hex, 5/16 in.	CP30M1000P 2

Parts

Hardware Skin Pack (CPZ1912)

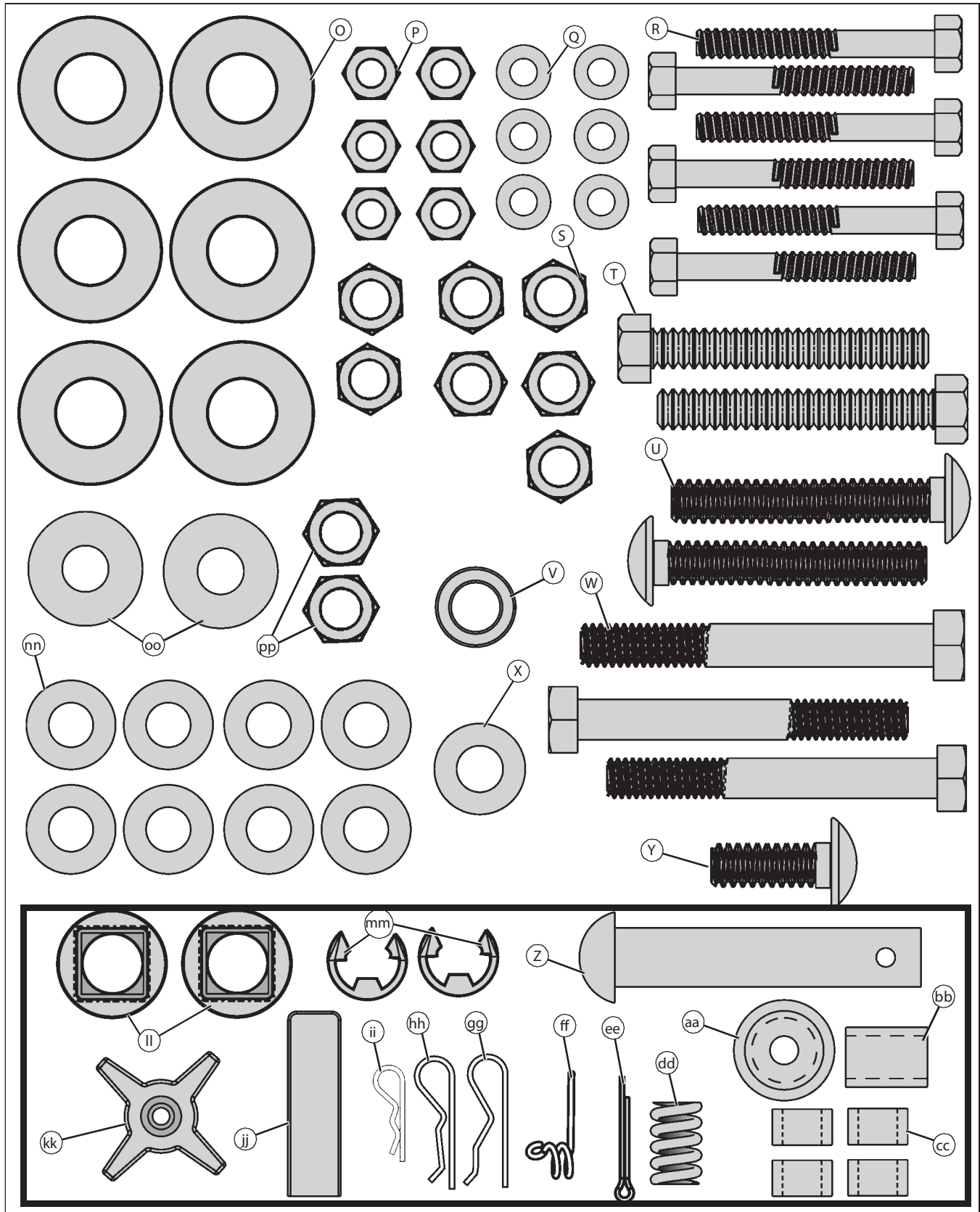

Picture Note: Parts shown above are full size except items in box.